

## FEATURES

- Dual Channel High Voltage Class-D Amplifier
- Advanced PWM Topology
- Adjustable Switching Frequency (500kHz Nominal)
- Wide Bandgap High Voltage SiC MOSFETs
- Externally Available Integrated 12V Supply (25W)
- Onboard Voltage, Current, Power, and Impedance Measurements
- Manchester Encoded LVDS Digital Input / Output



## BENEFITS

- Enables Direct or Magnetically Coupled / Matching Network Transducer Drive
- Modular, Scalable, and Reconfigurable
- Flexible Digital Interface
- FPGA Based Control Enables Reconfigurability
- Designed for MIL-STD Applications in Harsh Environments
- Modular Packaging
- Made in the United States



## PERFORMANCE

- **Input Voltage:** 100 - 300VDC
- **Out Voltage (Direct Drive):**  
Up to 200V<sub>RMS</sub>, Reconfigurable
- **Output Voltage (Transformers):**  
Up to 200V<sub>RMS</sub>, Reconfigurable
- **Bandwidth:** 1kHz - 100 kHz
- **Power Level Continuous:** 100W/Channel
- **Power Level Peak (Low Duty Cycle):** 500W

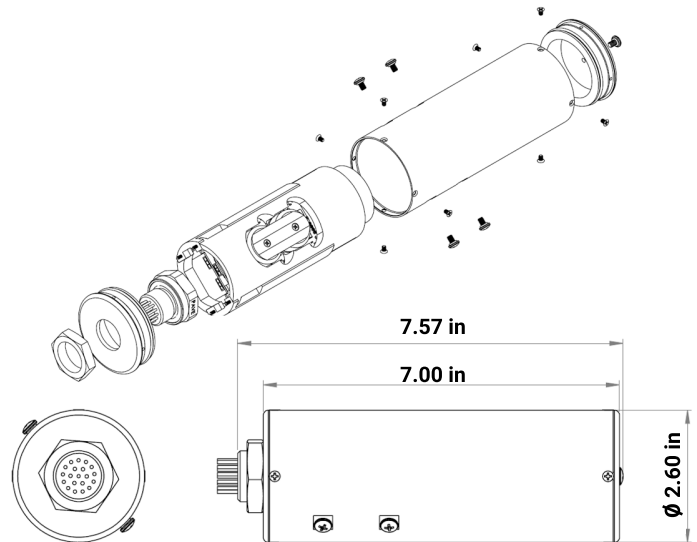

Nominal Amplifier Response - Direct Drive  
(10nF Load Capacitance)

